

## Freestanding Blue Jay



Collection No. 12978  
1 Design/5 Files

# MATERIALS



## Isacord Thread Colors

- 0010 Silky White
- 0020 Black
- 0111 Whale
- 0771 Rattan
- 0851 Old Gold
- 0945 Pine Park
- 1134 Light Cocoa
- 3630 Sweet Boy
- 3722 Empire Blue
- 5833 Limabean

**Note: One spool of 1000 meter thread is adequate for the project unless otherwise noted.**





# MATERIALS



## Stabilizers

- OESD AquaMesh WashAway
- OESD BadgeMaster WashAway
- OESD StabilStick CutAway
- OESD Fiber Form
- OESD Applique Fuse and Fix

## Fabrics/Textiles

- Blue Felt  
(2) 6" x 6" 12978-01  
(2) 2 1/2" x 9" 12978-02
- White Felt  
(2) 2.5" x 8" 12978-01
- Brown Quilter's Cotton  
(1) 6.5" x 6.5" 12978-03
- Tan Quilter's Cotton  
(1) 4" x 4" 12978-04

## Notion & Tools

- OESD Alligator Clamps
- OESD Button Clips
- OESD Expert Embroidery Tape  
TearAway
- OESD Expert Embroidery Tape  
WashAway
- OESD Perfect Punch Tool
- OESD MiniMAT
- OESD Perfect Embroidery Press Cloth
- OESD Grippy GRID
- Embroidery Needle Sharp 75/11 (FSA)
- Embroidery Needle Ballpoint 80/12 (FSL)

## Isacord Thread Colors

- Per the thread chart
- Match bobbin thread to top thread



# SUMMARY



Embroidery Hoop to accommodate: 3.71" x 8.5"  
Finished project size: Size 5.75" H x 5.5" W x 5.5" D

12978-01



Requires 1 Design

12978-02

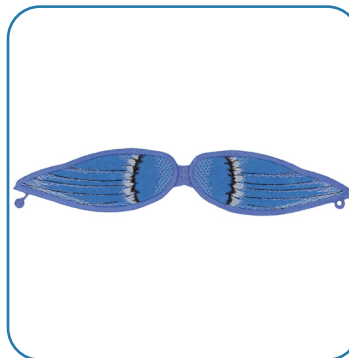

Requires 1 Design

12978-03

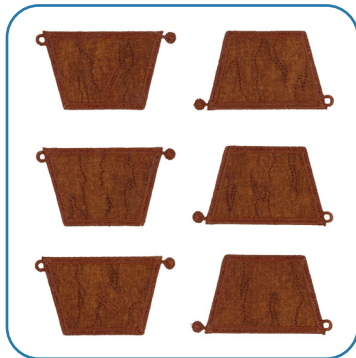

Requires 1 Design

12978-04



Requires 1 Design

12978-05



Requires 1 Design





## General Instructions

The freestanding applique instructions, included in the collection, are general instructions. For demonstration purposes, a sample design that best demonstrates the technique is shown. Fabric and thread requirements will vary by design, but the general technique is the same. All designs are stitched with matching thread, top and bobbin.

Note: Some thread colors in instructions have been changed or digitally enhanced for better visibility.

### Step 1

- Print the mirrored version of the templates (at 100% scale or 1:1 ratio) onto the paper side of Applique Fuse and Fix.
- Cut approximately 1/4" - 1/2" outside the printed applique templates.



### Step 2

- Cut the Fiber Form 1/4"-1/2" larger than the applique templates.
- Fuse the trimmed templates to the back of the Fiber Form with the paper side of the printed template up. Hold the iron on the template for 10-15 seconds for a secure fuse.



### Step 3

- Trim the Fiber Form on the edge of the black outline.
- Set aside.



### Step 4

- Adhere one layer of StabilStick CutAway to the wrong side of all applique fabrics, to provide stiffness to the finished structure.
- Cut the prepared applique fabrics 1/4"-1/2" larger than the templates that are included at the end of the instructions.

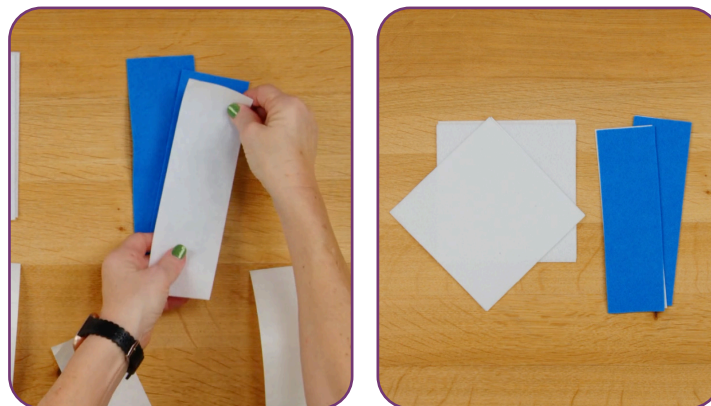

## □ Step 5

- Hoop one layer of AquaMesh and one layer of BadgeMaster for all designs.

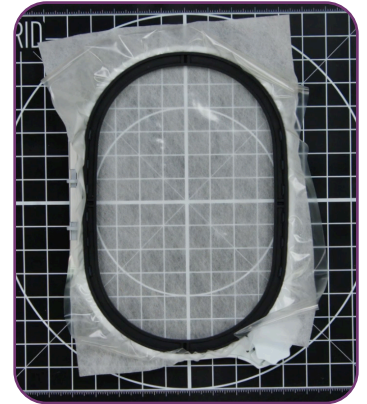

## □ Step 6

- Load selected design into the machine.
- Example design is 12978-01.
- Thread the machine per the thread chart.
- Place the hoop on the machine.
- Stitch Machine Step 1, Fiber Form Placement Stitch.



## □ Step 7

- Remove the hoop from the machine, but NOT the project from the hoop.
- Place the hoop on a flat surface.
- On the back of the Fiber Form, score and remove the paper backing to reveal the adhesive surface.
- Place the Fiber Form within the placement stitching.
- Finger press to secure.





## Step 8

- Return the hoop to the machine.
- Stitch Machine Step 2, Cut Line and Tackdown.



## Step 9

- Stitch Machine Step 3, Front and Back White Felt Placement Stitch.



## Step 10

- Remove the hoop from the machine, but NOT the project from the hoop.
- Place the hoop on a flat surface.
- Completely cover the placement stitch with the prepared white felt.
- Tape in place to secure.



## Step 11

- Turn the hoop over and place the prepared white felt right side up, completely covering the placement stitch.
- Carefully tape to secure.  
Tip: Avoid pushing too hard on the stabilizer to prevent it from dislodging from the hoop.



## Step 12

- Return the hoop to the machine.
- Stitch Machine Step 4, Cut Line and Tackdown.



## Step 13

- Remove the hoop from the machine, but NOT the project from the hoop.
- Place the hoop on a flat surface.
- Trim the excess fabric as close to the cut line stitching as possible.  
**Note:** If the outermost stitches (cut line) are cut, the inner stitches (tackdown) will hold the applique in place.
- Tip: If the stabilizer is cut or a hole is created while trimming the fabric, use OESD Expert Embroidery Tape WashAway as a patch.



## Step 14

- Turn the hoop over and trim the excess fabric as close to the cut line as possible.



## Step 15

- Return the hoop to the machine.
- Stitch Machine Step 5, Front and Back Blue Felt Placement Stitch.



## Step 16

- Remove the hoop from the machine, but NOT the project from the hoop.
- Place the hoop on a flat surface.
- Completely cover the placement stitch with the prepared blue felt.
- Tape in place to secure.





## □ Step 17

- Turn the hoop over and place the prepared blue felt right side up, completely covering the design.
- Carefully tape to secure.



## □ Step 18

- Return the hoop to the machine.
- Stitch Machine Step 6, Cut Line and Tackdown.



## □ Step 19

- Remove the hoop from the machine, but NOT the project from the hoop.
- Place the hoop on a flat surface.
- Trim the excess fabric as close to the cut line stitching as possible.



## Step 20

- Turn the hoop over and trim the excess fabric as close to the cut line as possible.



## Step 21

- Return the hoop to the machine and stitch the remaining steps per the thread chart.
- Match the bobbin thread to the upper thread.



## Step 22

- When the design is complete, remove the project from the hoop and trim the stabilizer 1/4" - 1/2" outside the design.



# GENERAL FREESTANDING LACE GUIDE



## Stabilizer

- OESD AquaMesh
- OESD BadgeMaster

## Notion/Tools

- 80/12 Embroidery Ballpoint Titanium needle for extended needle life
- OESD Alligator Clamps
- OESD Button Clips
- OESD Perfect Point and Press Tool

## Isacord Thread Colors

- All OESD designs are digitized with Isacord 40 wt. polyester thread as the top thread and in the bobbin.
- Refer to the thread chart for color specifications.
- Match bobbin thread color to the top thread.

## Instructions

### Step 1 - Hoop

For FSL structures, hoop one layer of OESD AquaMesh and one layer of OESD BadgeMaster. BadgeMaster contains more starch so, combined with the AquaMesh, the lace is more rigid. For other FSL, where a softer lace is desired, hoop two layers of AquaMesh.

### Step 2 - Embroider

Stitch the design per the thread chart with matching thread in the bobbin at each color change. When complete, remove from the hoop and trim away excess stabilizer about 1/4"-1/2" from the stitching.

### Step 3 - Rinse

Rinse remaining stabilizer out in warm running water. For stiffer lace and FSL structures, DO NOT rinse away all of the stabilizer. The lace should be just slightly tacky. For softer lace, rinse until all traces of the stabilizer is removed.

### Step 4 - Dry

Lay right side down flat on a non-stick surface, such as a cookie rack, parchment paper or Teflon sheet. This minimizes the tendency for the lace to curl. Let the pieces dry completely before proceeding with any assembly.

### Step 5 - Press

Once completely dry, press right side down on a OESD Perfect Embroidery Press Cloth.

### Step 6 - Assemble Structure

Note: Specific assembly instructions for a design/collection may be found in the thread chart pdf following the individual design color charts. Lace must be COMPLETELY DRY before assembly. Wetting the buttonettes or eyelets to assemble is not recommended and may result in them stretching and coming "unbuttoned" when dry. Use a pair of OESD Alligator Clamps to insert the buttonettes into the eyelets. Insert the tip of the OESD Alligator Clamps into the eyelet, grasp the buttonette and pull through the eyelet. Alternatively, use a stiletto or tweezers to push the buttonette through the eyelet.

## Helpful Tips

### Limp Lace

If the design is not stiff enough, press the lace pieces on the wrong side while applying spray starch. After ironing, spray again with starch and allow to dry completely. This will stiffen the lace pieces nicely and aid in construction. Or easily re-stiffen by diluting some stabilizer scraps in water (or use liquid starch) and dipping the item in the solution. Lay flat to dry.

### Eyelets Too Small

If any of the eyelets appear closed or too small to penetrate with Alligator Clamps, they may be stretched by inserting the small end of the OESD Perfect Point and Press Tool into the eyelet opening and stretching it open wide enough to accommodate the OESD Alligator Clamps.

### Button Clips

During the assembly process, some structures pull on buttonettes that have already been inserted and could pull them out altogether. Putting a Button Clip on the assembled buttonette will keep it in position during the assembly process. Remove the Button Clips when the assembly is complete.

### Alternative Construction Option

In some cases, the buttonettes may be pulled to the inside of a project, instead of being visible on the outside. Insert the OESD Alligator Clamps through the eyelet from the wrong, or inside, of the lace and grasp the corresponding buttonette. Pull the buttonette to the wrong side of the lace. Pulling the buttonettes to the inside may cause stress on the ones already done. Button clips may be placed on the completed buttonette(s) to prevent them from pulling out of the eyelet.



- Designs 12978-03 and 12978-04 use single sided applique techniques.
- This part of the instructions use example design 12975-10.

## □ Step 23

- Print the mirrored version of the templates (at 100% scale or 1:1 ratio) onto the paper side of Applique Fuse and Fix.
- Cut approximately  $\frac{1}{4}$ " -  $\frac{1}{2}$ " outside the printed applique templates.

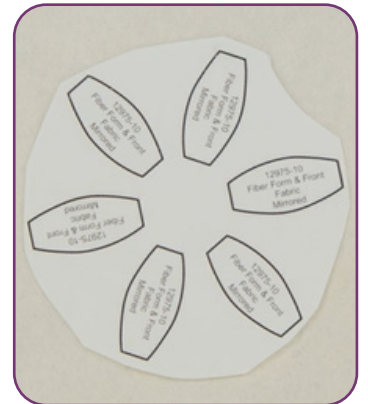

## □ Step 24

- Cut the Fiber Form  $\frac{1}{4}$ " -  $\frac{1}{2}$ " larger than the applique templates.
- Fuse the trimmed templates to the back of the Fiber Form with the paper side of the printed template up. Hold the iron on the template for 10-15 seconds for a secure fuse.

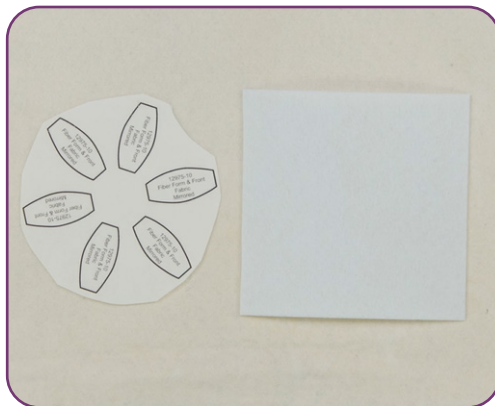

## Step 25

- Trim the Fiber Form on the edge of the black outline.
- Set aside.

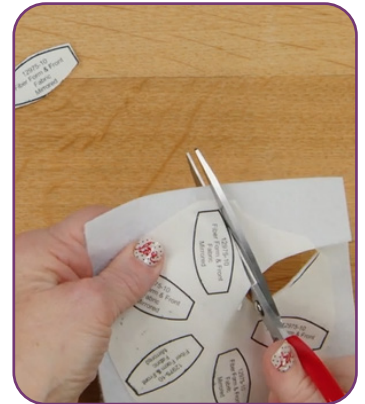

## Step 26

- Cut the prepared applique fabric 1/4"-1/2" larger than the templates that are included at the end of the instructions.
- Adhere one layer of StabilStick CutAway to the wrong side of all applique fabric, to provide stiffness to the finished structure.

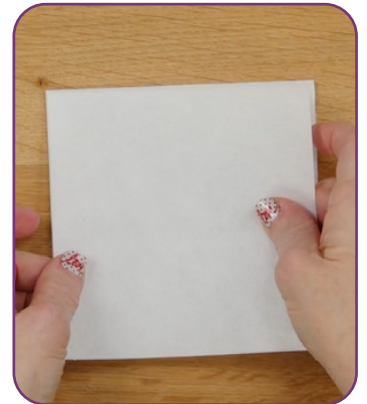

## Step 27

- Hoop one layer of AquaMesh and one layer of BadgeMaster for all designs.

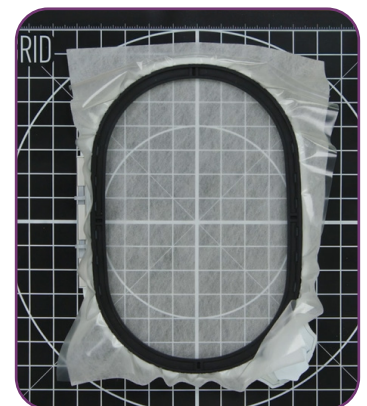





## □ Step 31

- Return the hoop to the machine.
- Stitch Machine Step 2, Cut Line and Tackdown.

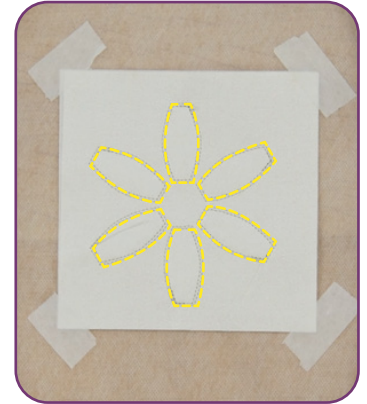

## □ Step 32

- Remove the hoop from the machine, but NOT the project from the hoop.
- Place the hoop on a flat surface.
- Trim the excess fabric as close to the cut line stitching as possible.
- **Note:** If the outermost stitches (cut line) are cut, the inner stitches (tackdown) will hold the applique in place.  
Tip: If the stabilizer is cut or a hole is created while trimming the fabric, use OESD Expert Embroidery Tape WashAway as a patch.







# ASSEMBLY

## Step 38

- Wrap the wings backward and match the eyelets of the Body FSA (12978-01) and the Wings FSA (12978-02) to the buttonette of the Wings FSA (12978-02).
- Use Alligator Clamps to pull the buttonette through the eyelet.

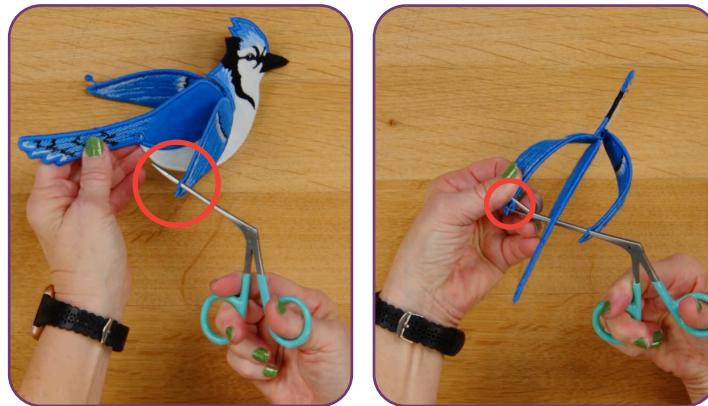

## Step 39

- To connect the Stump Sides FSA (12978-03) to the Stump Top FSA (12978-04), place the Stump Top right side up and align the Stump Sides right side up around the edges of the Stump Top as shown.
- Thread the sewing machine with matching thread on the top and bobbin.
- Stitch together using a multi-step zigzag stitch.
- Back stitch at the beginning and end to secure.
- Trim thread tails.

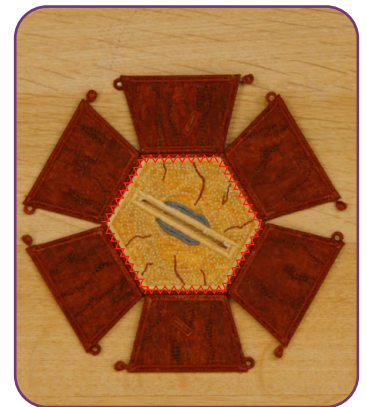



# ASSEMBLY

## □ Step 40

- Match the buttonettes to the eyelets of the Stump Sides FSA (12978-03).
- Pull each buttonette through the corresponding eyelet, using button clips to temporarily hold them in place, as needed.

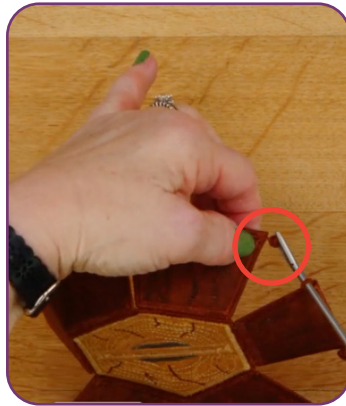

## □ Step 41

- Insert the locking tabs of the Stump Branches FSL (12978-05) into the branch slots on the Stump Sides FSA (12978-03).

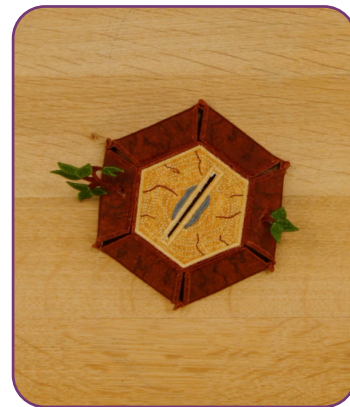
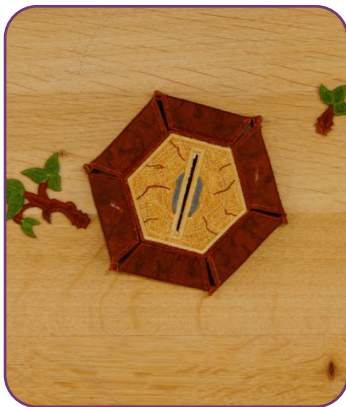

# EMBROIDERY

## Step 42

- Insert the assembled blue jay into the blue jay slot on the Stump Top FSA (12978-04).



## Step 43

- The project is complete. Enjoy!



# PUNCH TOOL GUIDES



12978-01



12978-03

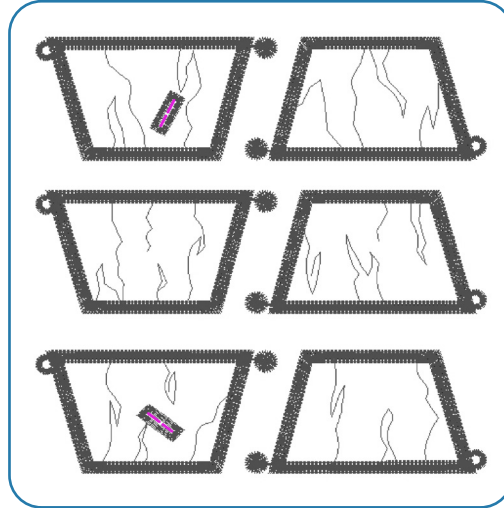

12978-04

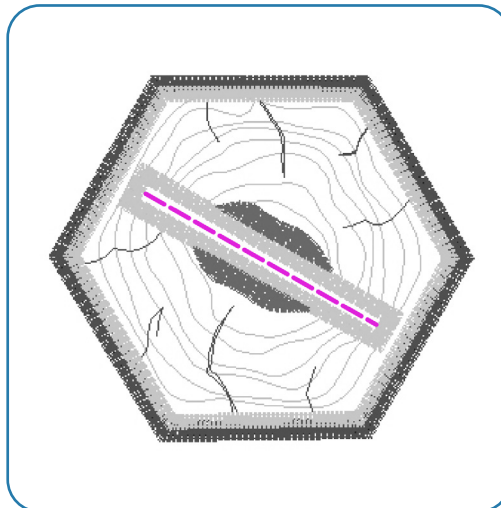

● = 2 MM

● = 3 MM

● = 4 MM

CRAFT KNIFE



## ATTENTION

When printing this document, any page scaling or page fitting options in your print dialog box must be turned OFF or set to NONE so that your files will print out at their actual size. Images not printed at actual size will not function as intended.

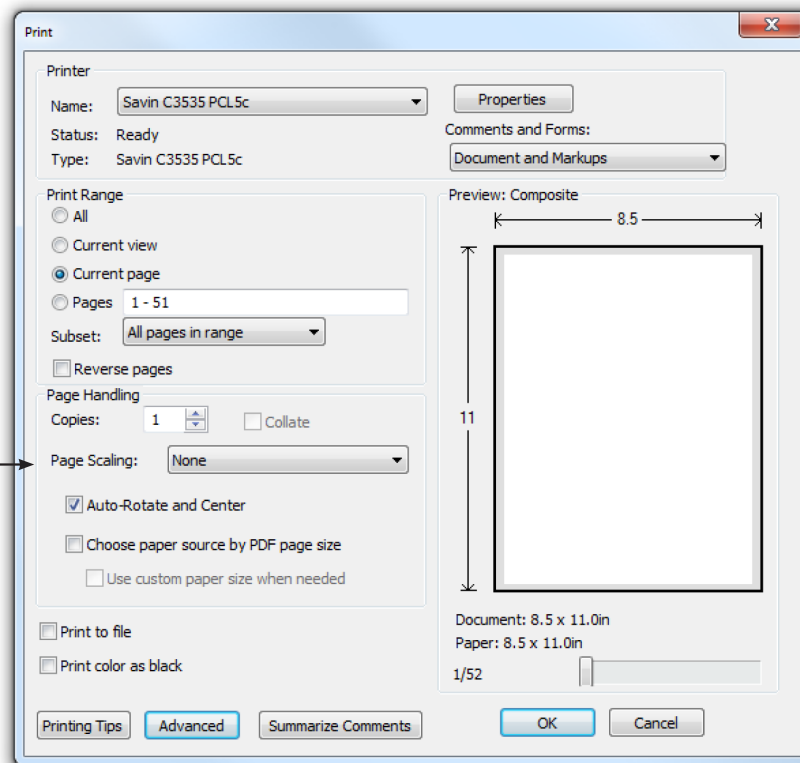

## TO SAVE PAPER

Only print the desired image by navigating to the image's page, go to File > Print and select "Current page" in the print dialog box. Repeat for each desired image.

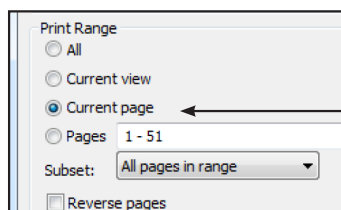



# APPLIQUE PATTERNS

**OESD**<sup>TM</sup> PREMIER  
COLLECTION

Print at 100%. No scaling. This box measures 1" x 1". Use the box as an accuracy guide when printing templates.

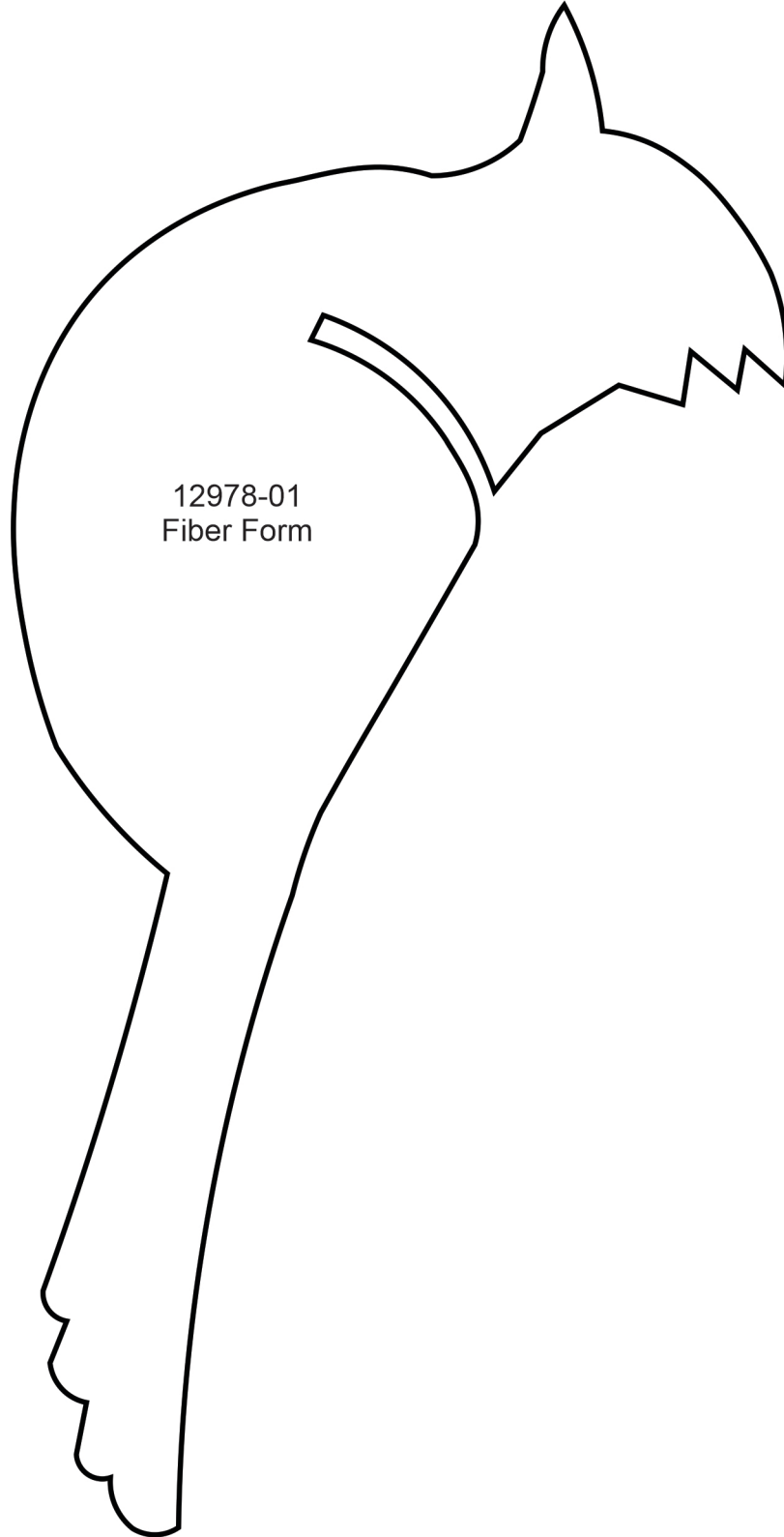

# APPLIQUE PATTERNS

Print at 100%. No scaling. This box measures 1" x 1". Use the box as an accuracy guide when printing templates.

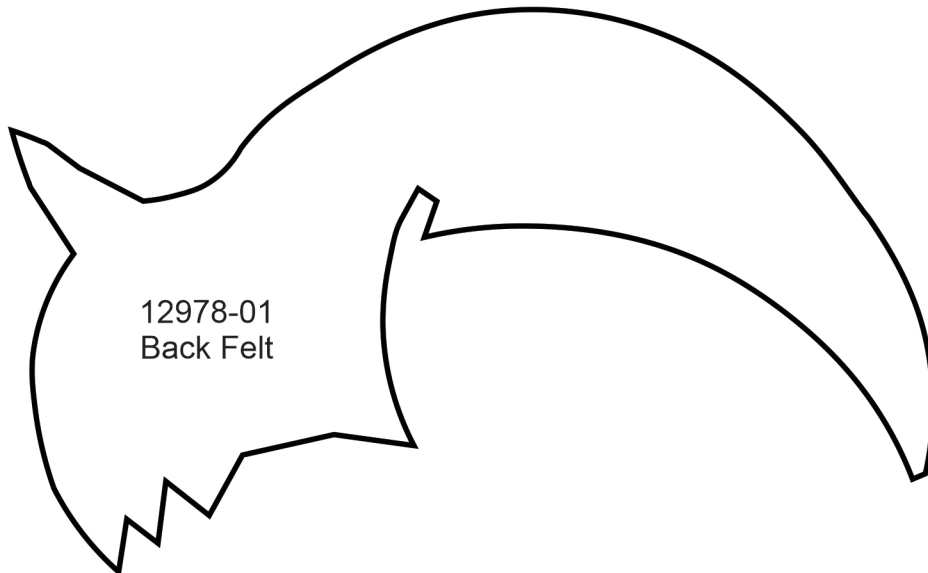
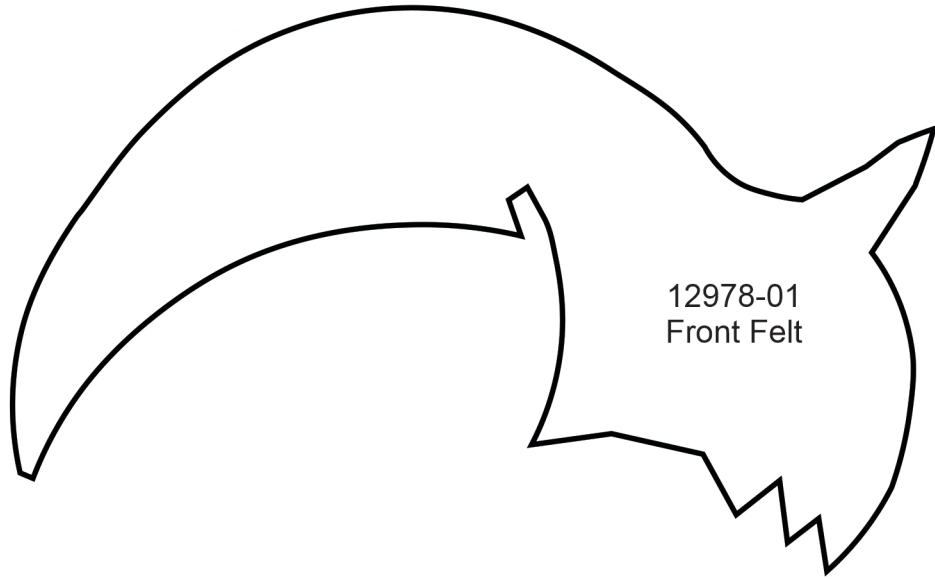

# APPLIQUE PATTERNS

**OESD**™ PREMIER  
COLLECTION

Print at 100%. No scaling. This box measures 1" x 1". Use the box as an accuracy guide when printing templates.

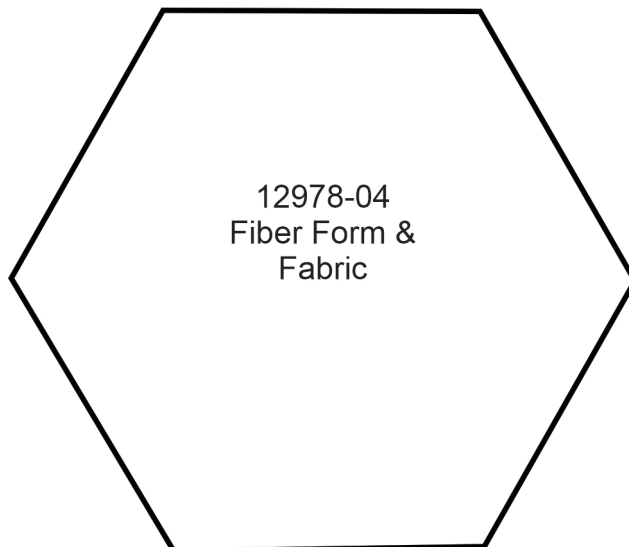
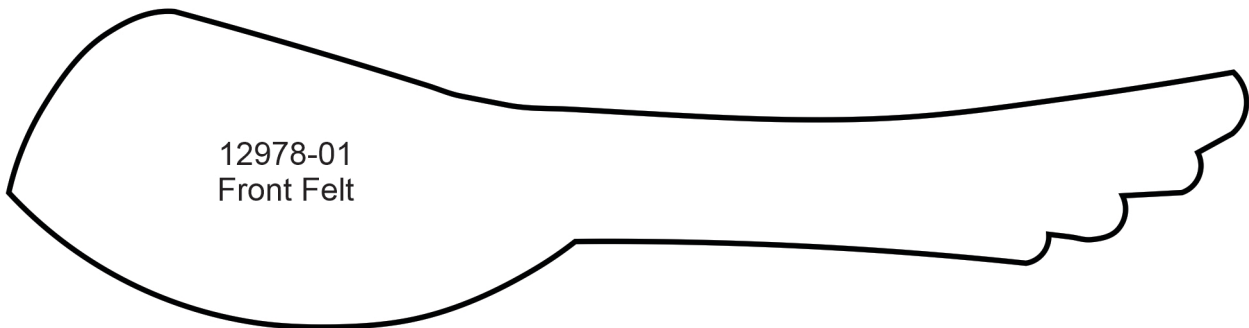
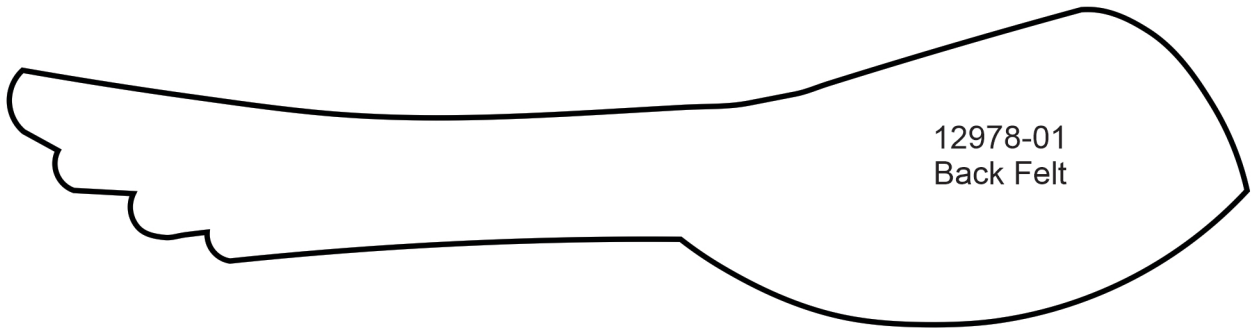

# APPLIQUE PATTERNS



Print at 100%. No scaling. This box measures 1" x 1". Use the box as an accuracy guide when printing templates.

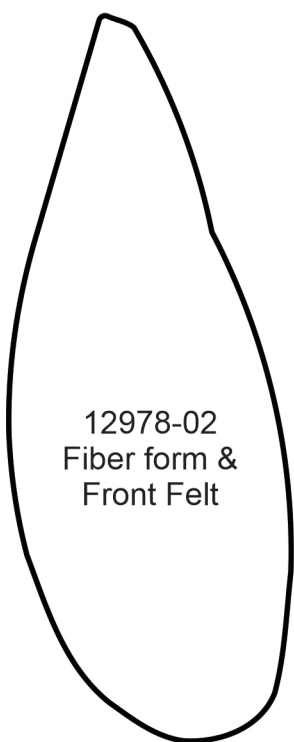

12978-02  
Fiber form &  
Front Felt

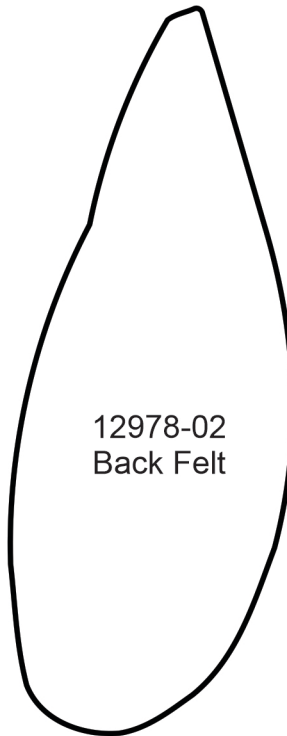

12978-02  
Back Felt

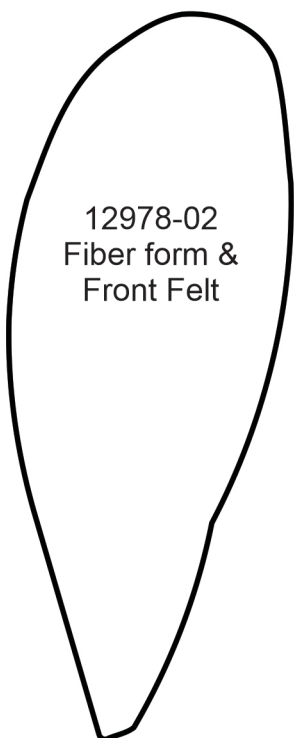

12978-02  
Fiber form &  
Front Felt

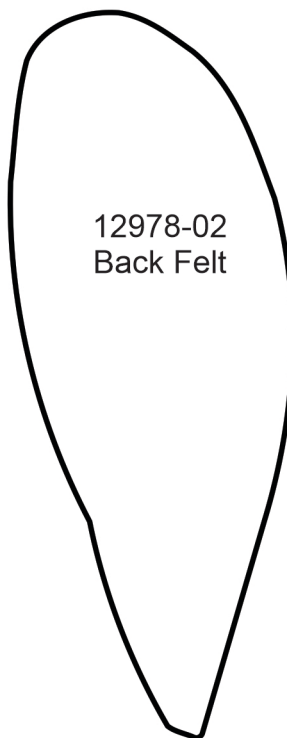

12978-02  
Back Felt



# APPLIQUE PATTERNS



Print at 100%. No scaling. This box measures 1" x 1". Use the box as an accuracy guide when printing templates.

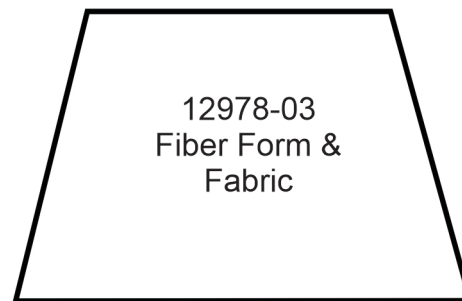
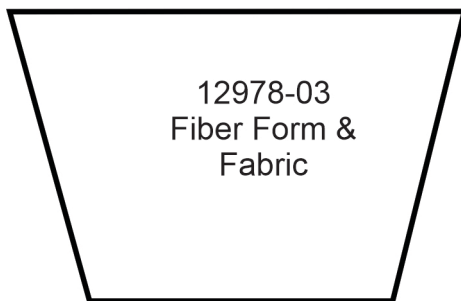
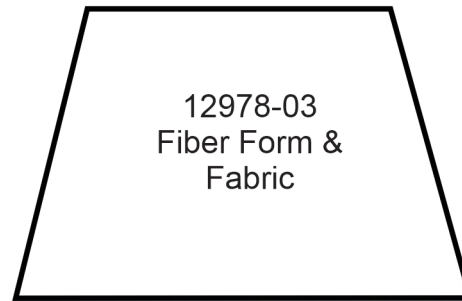
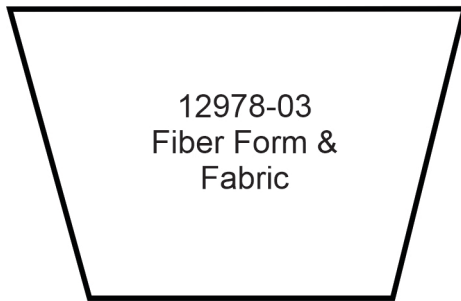
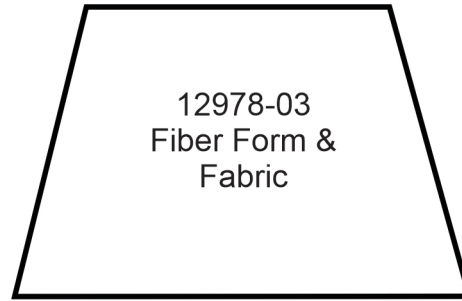
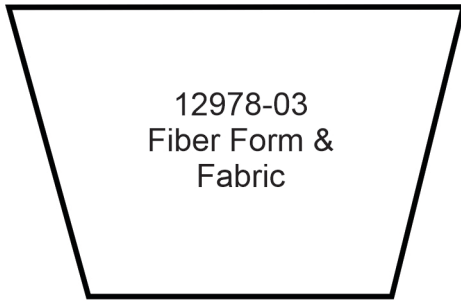

MIRRORED PATTERNS **oeSD**<sup>TM</sup> PREMIER COLLECTION

Print at 100%. No scaling. This box measures 1" x 1". Use the box as an accuracy guide when printing templates.

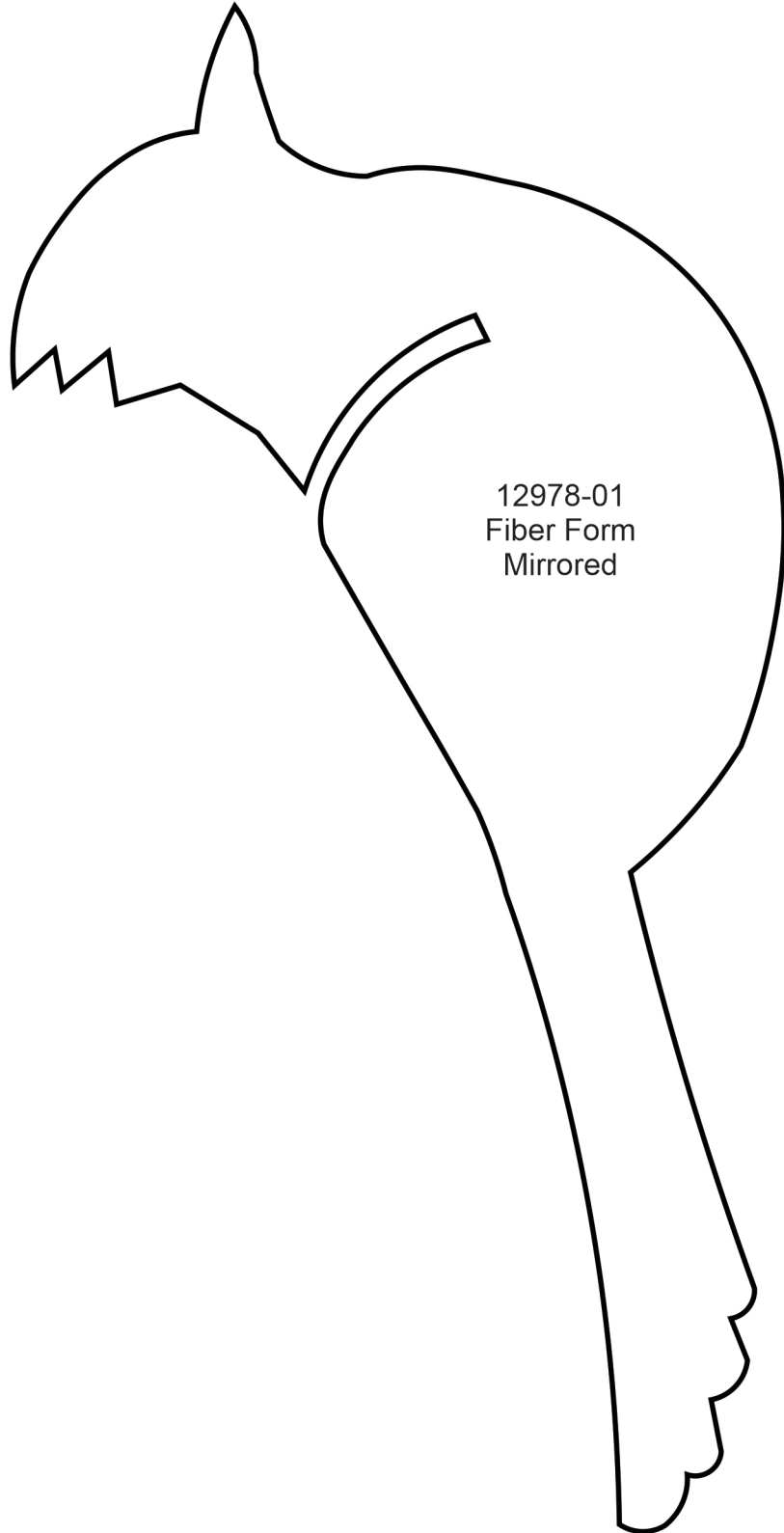

# MIRRORED PATTERNS PREMIER COLLECTION

Print at 100%. No scaling. This box measures 1" x 1". Use the box as an accuracy guide when printing templates.

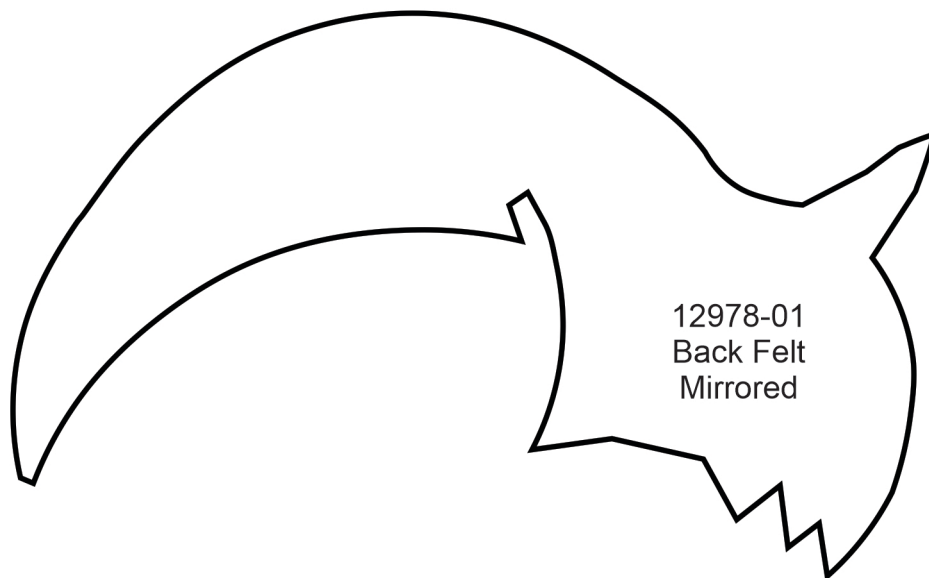
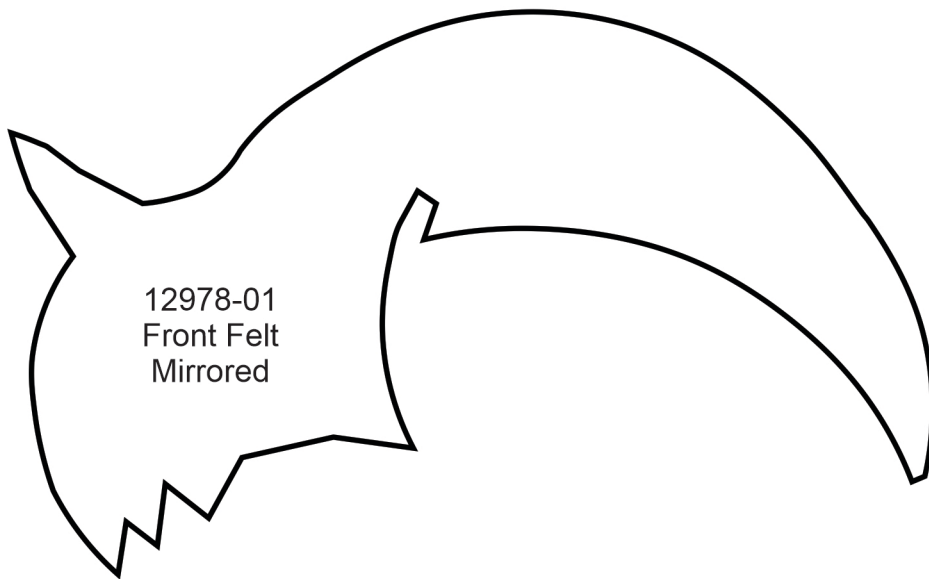

# MIRRORED PATTERNS PREMIER COLLECTION

Print at 100%. No scaling. This box measures 1" x 1". Use the box as an accuracy guide when printing templates.

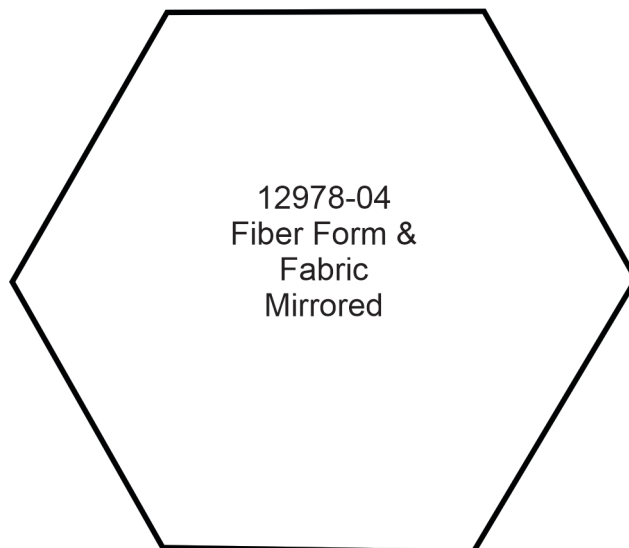
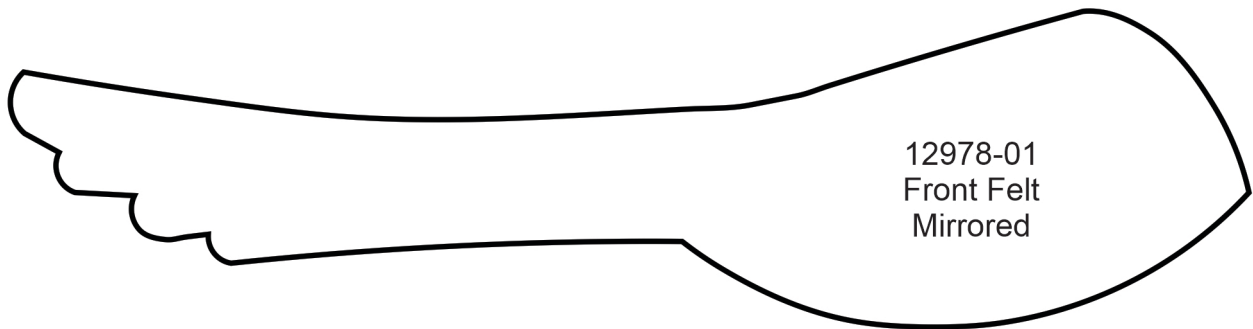
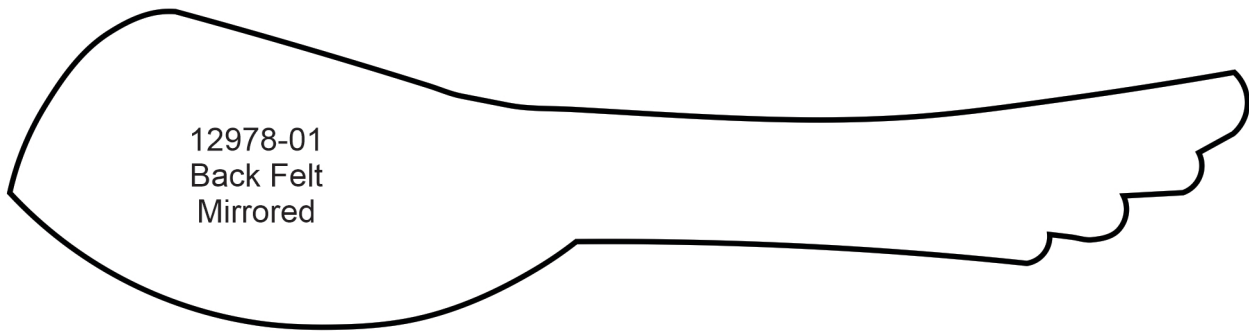



# MIRRORED PATTERNS



Print at 100%. No scaling. This box measures 1" x 1". Use the box as an accuracy guide when printing templates.

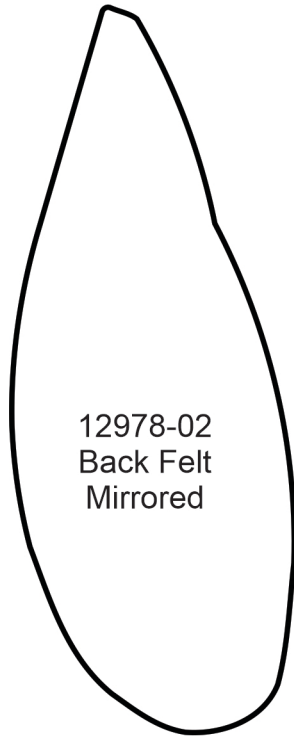

12978-02  
Back Felt  
Mirrored

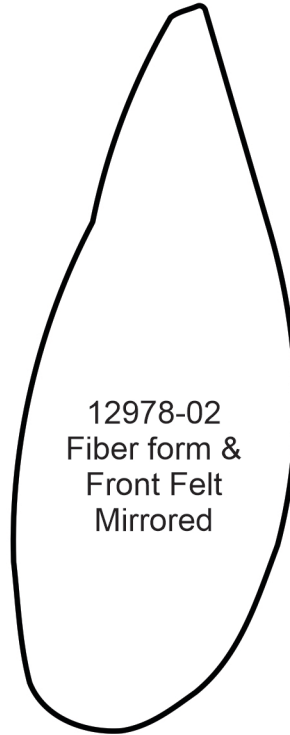

12978-02  
Fiber form &  
Front Felt  
Mirrored

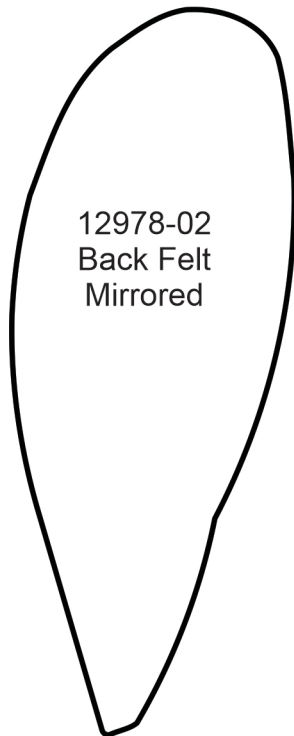

12978-02  
Back Felt  
Mirrored

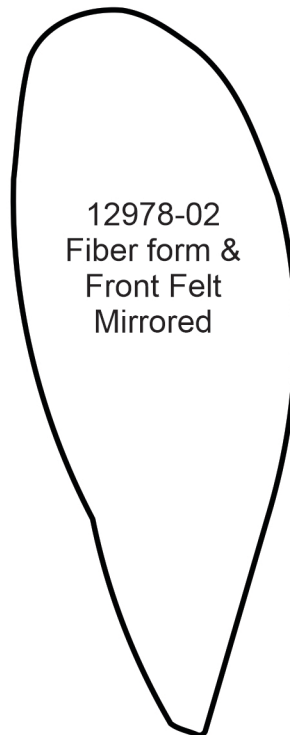

12978-02  
Fiber form &  
Front Felt  
Mirrored

# MIRRORED PATTERNS PREMIER COLLECTION

Print at 100%. No scaling. This box measures 1" x 1". Use the box as an accuracy guide when printing templates.

